



TYPICAL FLOOR PLAN



A Prestigious Project By:



Architect:



Site Address:

B/h. New Essar Petrol Pump, 18 mt. Road Touch, Nr. Earth Arise, B/s. Sky Marcs, Sama-Savli Road, Vadodra.

Corporate House:

S.F: 201, 202, 203, 206 Sakar Complex, Nr. Super Bakery, New VIP Road, Vadodra-19.
Ph.: 0265 2513087

For Booking Contact:

+91 72111 39987

www.shreenathjibuilders.com



**Shreenathji
PALACE**

**5 BHK
POSH FLATS
INCLUDING
PERSONAL OFFICE**

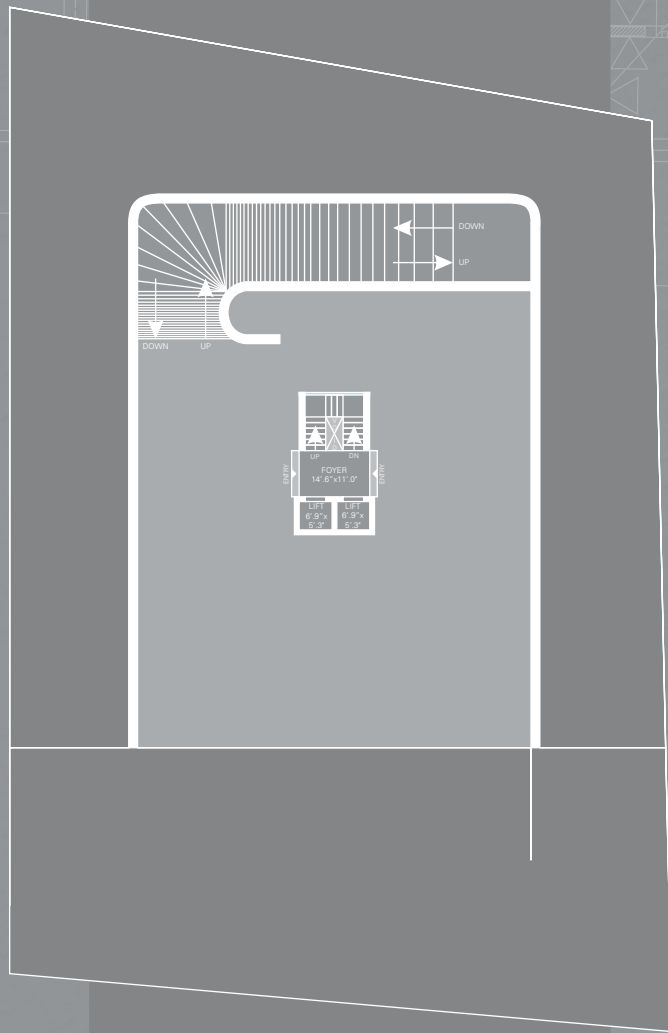

LOWER BASEMENT PLAN
(PARKING)

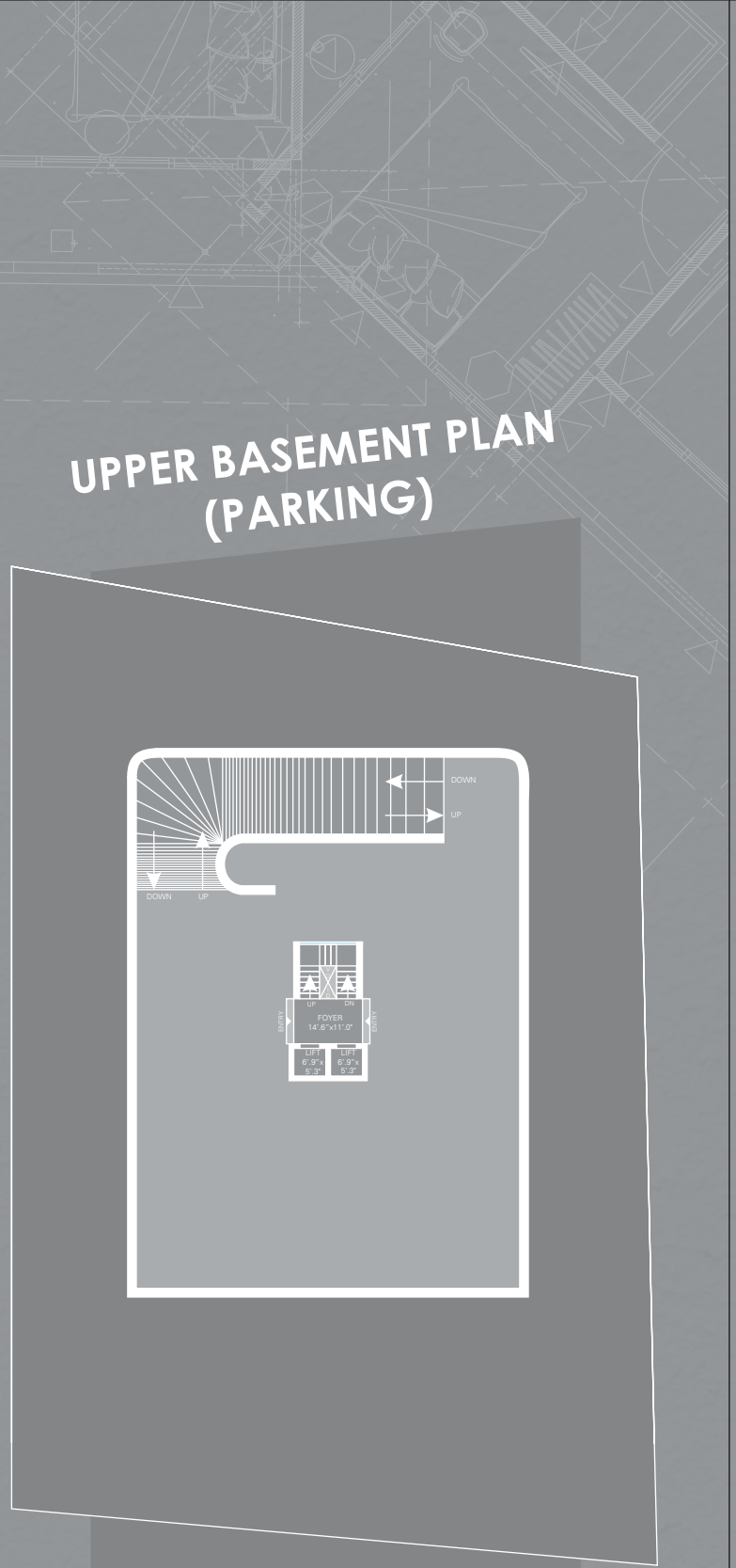

UPPER BASEMENT PLAN
(PARKING)

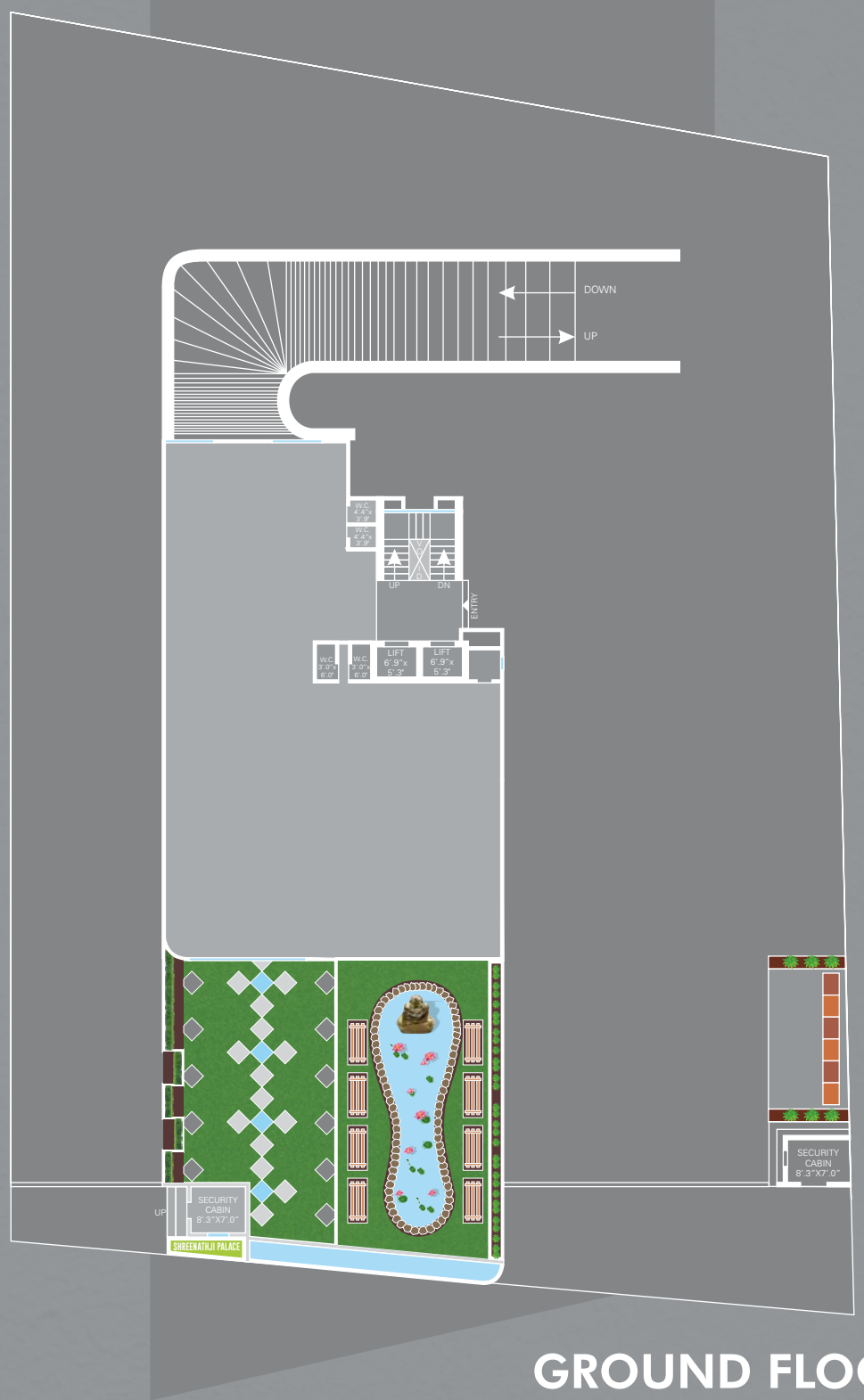



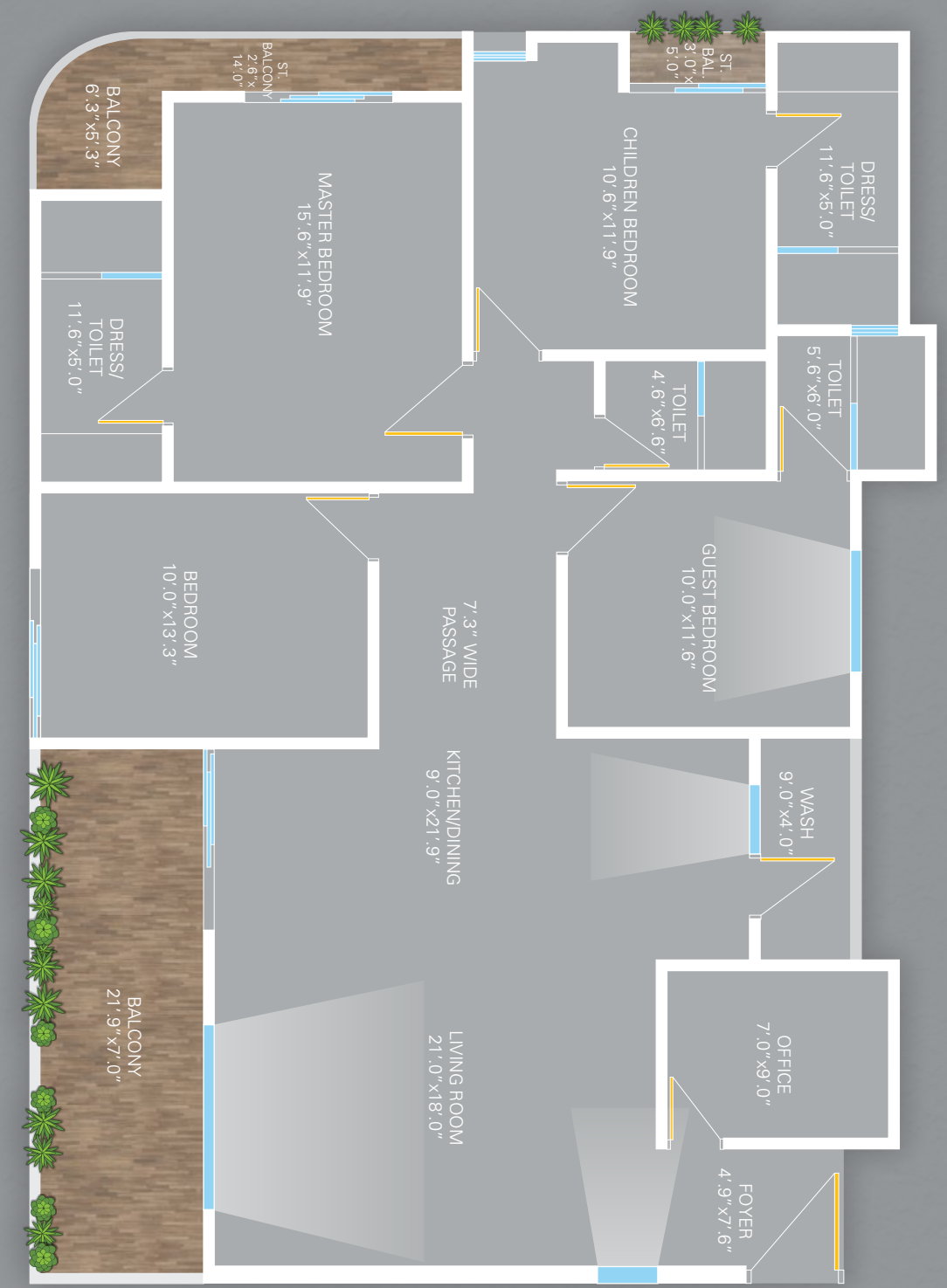





GROUND FLOOR PLAN



FLAT FLOOR PLAN
PLOT AREA: 1940 SQ. FT.

SPECIFICATION

- | | | | | |
|--|---|--|---|---|
|  Structure:
Earthquake resistant RCC framed structure. |  Flooring:
24"x48" vitrified nano tiles flooring in all rooms. |  Kitchen:
Granite platform with SS sink and branded wall tiles. |  Window:
Powder coated aluminum section windows with mosquito nets. |  Finishing:
Internal smooth plaster with standard quality putty & external double coat plaster with acrylic paint. |
|  Walls:
"A" class brick masonry. |  Bathroom:
Designer tiles up to lintel level with standard quality C. P. fittings. |  Doors:
Elegant entrance with Main door veneer & internal flush door with laminate. |  Parking:
Allotted car parking for each unit. | |

