

A Prestigious Project By:



The tradition of trust

www.shreenathjibuilders.com

Architect:



ARCHITECT'S CLUB
Architect & Interior Designer

Brijesh Shah

Site Address:

Shreenathji Dwar,
Before Gayatri Mandir,
Beside Ananta Shubh-Labh,
Khatamba, Vadodara.

Head Office:

S.F : 206 Sakar Complex,
Nr. Super Bakery,
New VIP road,
Vadodara-19.

For Booking Contact:

+91 72030 29987
+91 97379 76689

Legal Advisor:

Adv. Ajay Tripathi

OUR SUCCESS STORY:



THINK TANK - 9090 47799



4 BHK ULTRA
LUXURIOUS DUPLEX

LET THE GOOD TIMES BEGIN...

CHOOSING BETWEEN NATURE AND
MODERNITY CAN BE RATHER DIFFICULT.

Not anymore...

'Shreenathji Dwar' skillfully infuses both, to create eden in the heart of the city. Get spellbound with the picturesque scenic beauty of the environs along with the luxury and convenience of modern living.

Each duplex gives you the sense of space with much grandeur and style. Trend barefoot on lush green gardens with pristine blue sky above.



ABOUT THE GROUP

Shreenathji Builders has stamped its presence in the infrastructure field through different business interests, but the common fabric of quality and customer happiness runs through them all. It brings us immense pleasure to share our journey that has always focussed on setting benchmarks of quality for customer delight. With time it has become a habit with us to create better accomplishments for our endeared patrons.

Established in year 2015, Shreenathji Builders has emerged as the real-estate giants of Vadodara. Sprawling acres of residential and commercial spaces has made Shreenathji Builders a synonym of trust. Lead by **Mr. Daxesh D. Shah**, Shreenathji Builders has a team of professionals with the perfect blend of experience and expertise.

VISION AND MISSION

The mission of the group is to set benchmarks of global standards. Innovative designs, modern technology and a commitment to never compromise with quality has been their success mantra. A transparent and honest relationship with the suppliers and the customers' makes Shreenathji Builders stand taller in the market.

THE TEAM

"No matter how brilliant your mind or strategy, if you're playing a solo game, you'll always lose out to a team". These lines by Reid Hoffman says it all.

At Shreenathji Builders we believe in teamwork over solo work. The team consists of professionals who are master of their art. Each member of the team, whether a management official or a skilled labour, adds a unique perspective to the project.



LIVE LAVISH

...Because that's how we have designed it.

Shreenathji Dwar is an exceptionally designed residential community. Your **home here is large** and **rooms spacious**. And we have thoughtfully put together a number of facilities and features to ensure that you live your life to the fullest.

IMPERIAL ENTRANCE

The magical spell of charm awaits you. Magistic entrance gate welcomes you to the **world of joy and happiness...**



GROUND FLOOR

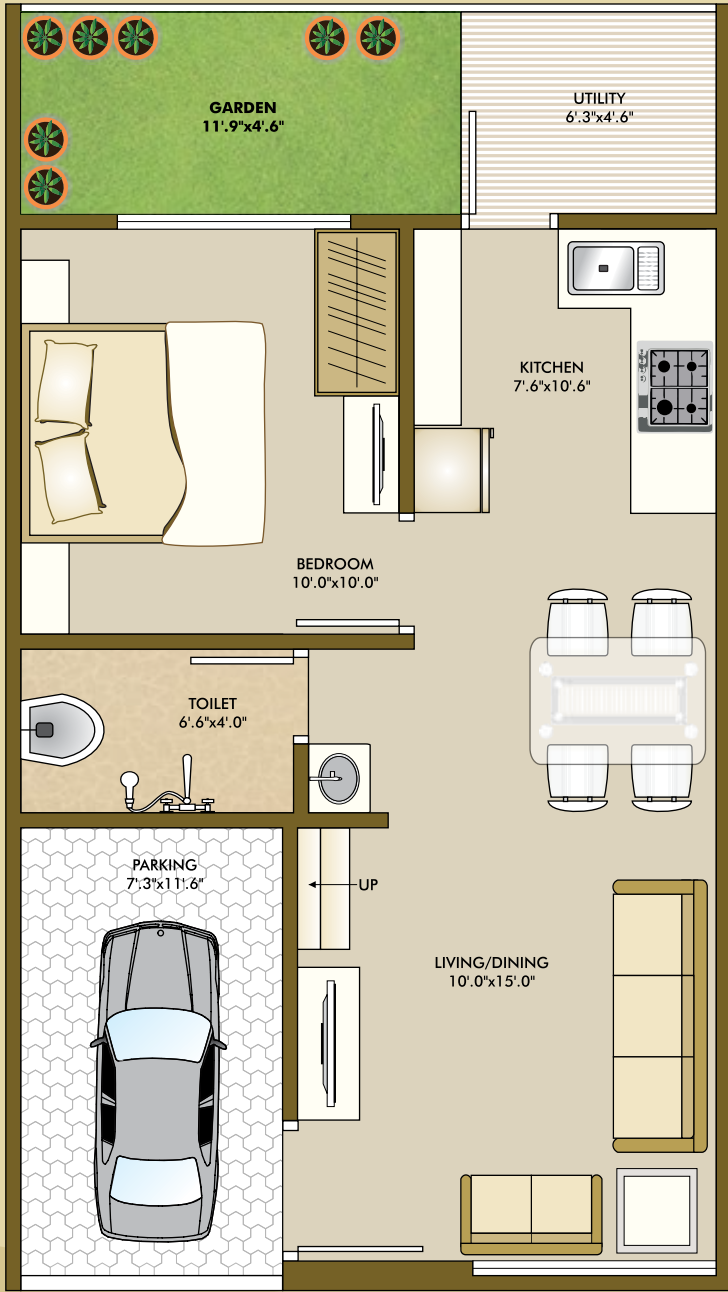

FIRST FLOOR

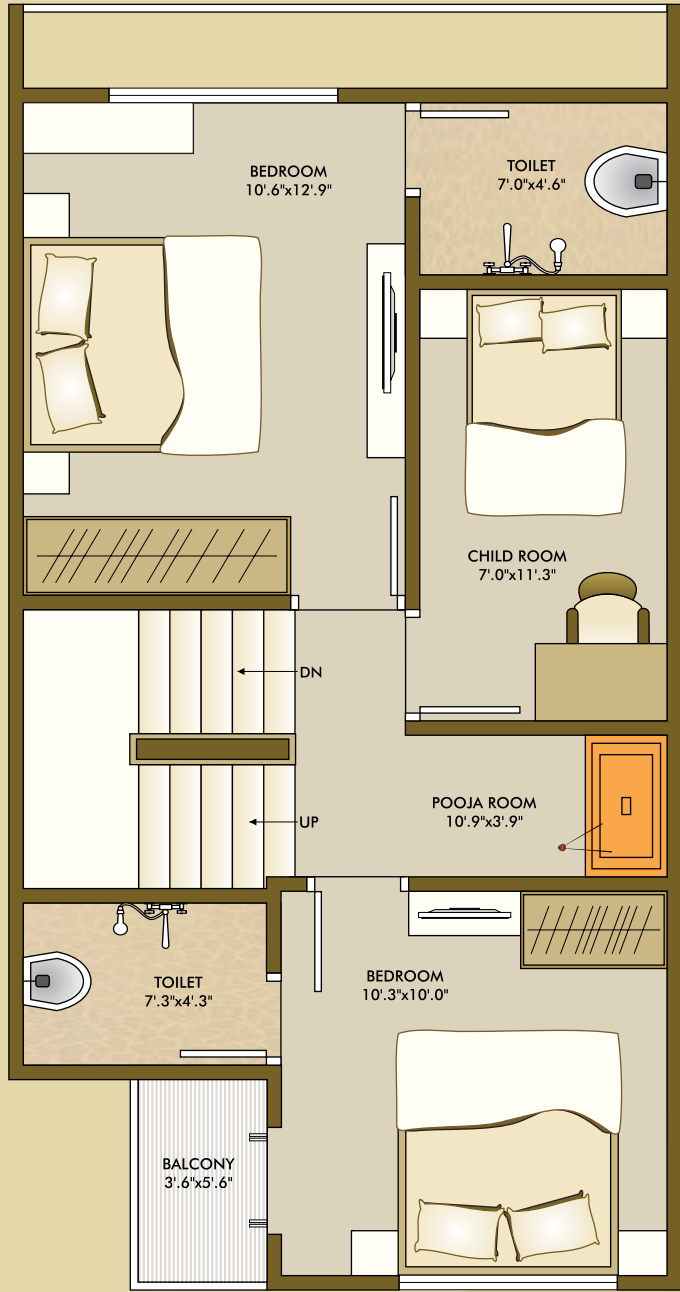



THE CLUBHOUSE

Live all colorful moments of life...

In your busy life, every moment of free time is precious. That's why we've taken care to place every leisure facility at your disposal. So every day you spend at Shreenathji Dwar is fun-filled and memorable. Take a leisurely stroll in the serene environs of the landscaped lush green garden.

A fully equipped club house to make your leisure moment a colourful treasure of a lifetime.

The club house includes:

- Gymnasium
- Table Tennis
- Pool Table
- Chess





AMENITIES

- Garden with sitting facility
- Jogging track
- Senior citizen area
- Sceneric water body
- Eco friendly surrounding environment with landscape
- 24 Hours water supply
- Designer entry gate with surrounding compound wall
- Internal RCC road & paved parking area
- 24x7 Security with security cabin
- Streetlight throughout campus
- Elegant name with number plate
- Heat & water proofing treatment on the terrace
- Anti termite treatment to the duplex
- Intercom facility between rooms & security cabin
- Front door security Audio-Video camera system





SPECIFICATIONS



Structure

Earthquake resistant RCC frame structure as per structure design.



Bathroom

Designer tiles up to top level with standard quality C.P. fittings.



Kitchen

Granite platform with SS sink and branded wall tiles.



Finishing

Internal smooth plaster with standard quality putty, primer & external double coat plaster with acrylic paint.



Window

Colour anodized aluminum section windows with mosquito nets.



Doors

Elegant entrance with Maindoor veneer & internal flush door with laminate.



Flooring

2'x2' Vitrified nano tiles flooring in all rooms.



Electricity

Concealed copper wiring with good quality switches sufficient electrical point in kitchen and all rooms and AC point in master bedroom.

BRANDS WE USE





PAYMENT SCHEDULE :

- 25% Booking
- 40% Plinth level
- 10% Slab level
- 10% Brick work
- 10% Plaster level
- 5% Finishing

DISCLAIMER:

Premium quality materials or equivalent branded product shall be used for all construction work. - Right of any changes in dimensions, design & specifications will be reserved with the developer, which shall be binding for all members. - External changes are strictly not allowed. - Development charges, documentation charges, stamp duty, all municipal taxes, service tax, G.E.B. Meter deposit should be levied separately. - Each member needs to pay maintenance deposits separately - In case of booking cancellation, amount will be refunded from the booking of same premise after deducting 10% of booking amount - Possession will be given after one month of all settlement of account. - Extra work at the cost of client with prior estimate needs to be given in advance but no change in elevation and plan will be done. - The developer reserve the full right to make any changes. - This brochure does not from a part of agreement or any legal document, It is easy display of project only.

Loan facilities available by:

